



New 114' to 125' Series Tri-deck Motoryachts



NORTHSTAR 114 Tri-deck Motoryacht

New 114', 120' and 125' Tri-deck Motoryachts



These NORTHSTARS feature an on-deck master stateroom with full beam, his and hers heads featuring etched glass enclosures for the Jacuzzi tub, granite counter tops and stone floors, cedar lined walk-in closet, and elegant joinery with wood and fabrics selected by the owner.

Entry to the *lower staterooms* is by a winding staircase extending from the sky lounge, through the entry foyer, and to the lower deck foyer. The *grand central staircase* is a piece of art in itself.

There are a number of layout options; the one shown features a large *full beam VIP suite* with settee, desk, and his and hers heads providing the guests with the luxuries of a typical master stateroom. Aft of the foyer are two guest staterooms with ensuite heads

Entry to the *spacious salon* is from the main entry foyer on the starboard side, or from the aft deck passing by a full bar positioned to serve the aft deck as well as the salon. The salon flows seamlessly into the formal dining area with seating for eight.

The galley is enormous with room for more than one "cook in the kitchen," and it has all the counter and storage space a gourmet chef could want, including a dumbwaiter

for serving the sky lounge and upper alfresco dining area. Across from the galley is a large pantry for long trip provisioning. The galley can be accessed from the port side deck, and it provides stair access to the forward crew quarters and lounge on the lower deck.

The upper deck is accessed through the central winding stairway, aft deck stairs, or the side deck stairs. The pilothouse provides access to the side stations, side exterior stairs, Portuguese bridge and foredeck through side doors. *The pilothouse is roomy* with great visibility and includes three helm chairs and comfortable settees for the guests, so that everyone has a place to watch the action.

This deck includes a *spacious sky lounge* providing a panoramic view of the surroundings. It can be easily closed off from the pilothouse for night runs; the sky lounge includes a day head, work station, full entertainment center, and plenty of seating.

Aft of the sky lounge is the *alfresco dining area* including a table with seating for eight and amenities such as built in cabinets, stainless steel refrigerator/icemaker, sink and BBQ. The boat deck includes a tender with plenty of additional room for other water toys.



Interior photos are of NORTHSTAR sisterships



The sun deck is the perfect place to relax, and includes a fully equipped bar, Jacuzzi, plenty of seating and sun pads. As an option, this deck can be configured as a sky bridge with helm seats and electronics of the owner's choice.

There are accommodations for six crew. The **forward crew quarters and lounge** is accessed from the galley and is perfect for the chef and mate, and the aft crew quarters, which is accessed from the aft deck or cockpit, has two staterooms with ensuite heads.

These NORTHSTARS includes a unique **sound insulated bilge Pump Room** which is centrally located and contains all pumps for the yacht—water, waste, heads, etc. In addition it has storage for all related filters and tools, so that the crew can fully and conveniently service all pumps in one easily accessed location.

Additional features

This NORTHSTAR series can be configured as a 114' Motor Yacht with a large swim step or as a Cockpit Motor Yacht, bringing the total length to 120', with a 125' version.

The wide side decks facilitate safe and easy movement around the yacht, and the overall configuration allows crew to move about the yacht without disturbing the owner or guests.

Access to the galley and forward crew quarters is from the port side, and access to the engine room, utility room, and aft crew quarters is from the port aft deck or through the transom. The main owner and guest entrance is on the starboard side. Pilothouse, sky lounge, Portuguese bridge and foredeck can be accessed by the central stairs, the aft deck stairs or side deck stairs which are recessed into the superstructure.

Built to ABS/MCA compliance makes this yacht suitable for charter and provides the owner and captain with the assurance that the yacht is built to the highest standards. Every NORTHSTAR is built to run off-shore with confidence and safety.

These NORTHSTARS include an integrated electronics package at the helm and wing stations, bow and stern thrusters, twin 16V2000, 2400hp Detroit/MTU's, Delta-T ventilation and a demister system to keep the engine room dry. The electrical system includes integrated distribution panels, two 55kw Northern Lights generators, one 100 amp shore power cord on each side using Glendenning Cablemaster's.



Specifications:

Each model is available in either 4 or 5 stateroom arrangements with ensuite heads. Accommodations for a crew of 6 with ensuite heads and lounge.

Naval architect: Jack Sarin

Draft	6'
Fuel, diesel	6,500 gals
Water	1000 gal
Holding tank	450 gals
Grey Water	200 gals

114' Tri-deck Motoryacht

Length overall	113'10"
Length at waterline	100'10"
Beam	25'4"
Displacement	Full load 352,000 lbs Light load 298,000 lbs

120' Tri-deck Cockpit Motoryacht

Length overall	119'11"
Length at waterline	106'11"
Beam	25'4"
Displacement	Full load 360,000 lbs Light load 306,000 lbs

125' Tri-deck Motoryacht

Length overall	125'
Length at waterline	111'
Beam	27'6"
Displacement	Full load 430,000 lbs Light load 368,000 lbs

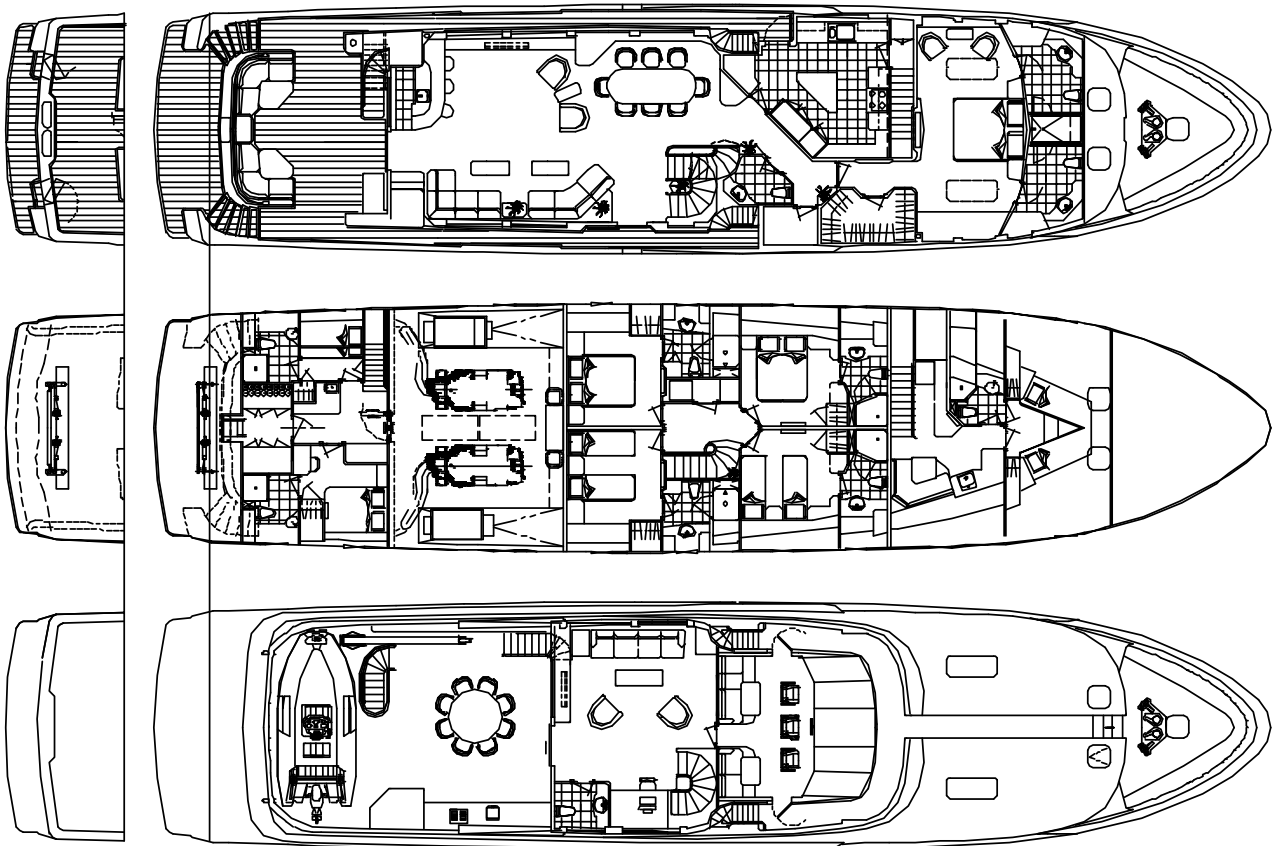

120'
stern

114'
stern

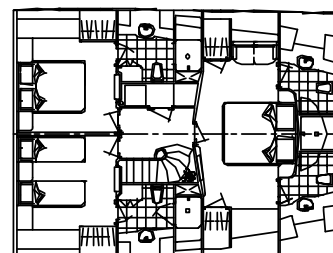
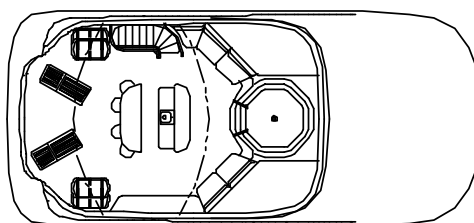

Optional
stateroom
arrangement